



A great place to put down roots.



**A PLACE TO
*PLANT***

**AMES COMMUNITY GARDEN
PROVIDES 129 PLOTS TO
GARDENERS IN THE COMMUNITY**

**A PLACE TO
*LEARN***

**"NEIGHBORS GET THEIR FINGERNAILS DIRTY
AND SWAP TIPS AND TALES AS THEY
LEARN ON THEIR AMES-SUPPLIED TOOLS"**

**A PLACE TO
*GROW***

SIGN-UP DETAILS INSIDE

A Place to *Grow*

When we help something grow, we grow ourselves. The Ames Community Garden offers people in the Capital Region a place to grow and express themselves through gardening.

In our community today, there are many people who would love to garden, but don't have the space. There are also those who would like to try gardening but don't know where to start. Ames wants to meet both these needs while also offering people the opportunity to improve their health by eating locally grown fruits and vegetables.

The Ames Community Garden opened to groups and individuals starting in spring, 2011. Our goal is to grow the love of gardening through:

- Preparing a place in our community where people of all ages can put down roots
- Spreading the opportunity for people in our community to have a place to garden
- Tending to the need for gardening education in our community
- Harvesting a bounty of fresh, nutritious foods for individuals, families and organizations in the area

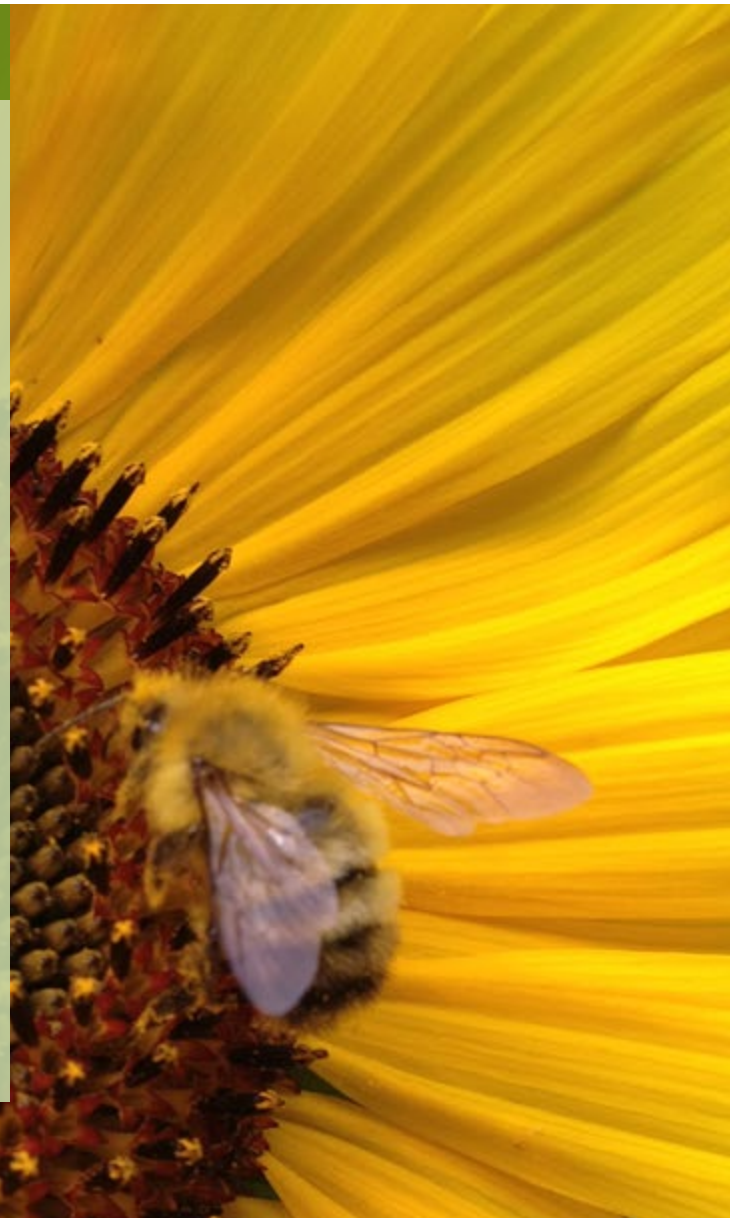

Planning for *Growth*

We are so committed to the Ames Community Garden that we built it right in front of our headquarters in Camp Hill, PA. The features of our garden include:

- 129 plots of varying size – suitable for everyone from groups to individuals
- Raised beds – offering better drainage and soil control
- Gardening tools provided in a permanent storage shed – every tool you need to plant, tend and harvest your garden. We want to make it easy for anyone to garden.
- Fenced Perimeter – offering security and peace of mind
- Water and hose access throughout the garden



If you are interested in having a plot in our garden, please contact our Community Garden Administrator. The Administrator's contact information is on the back of this brochure.



You can Help us *Grow*

Ames provided the materials and built the garden, but there are still ways to help.

One of our needs will be for individuals and organizations who want to help educate the public about gardening. We envision having people give advice at different points during the growing season on topics such as planting and tending your garden to harvesting and preparing your garden for winter.

Our other need is for gardeners. We want to reach as many people as we can to offer them a place to put down some roots. If you know of an organization or individual who would like to have a plot for gardening, please let them know about the Ames Community Garden. We especially see an opportunity for the garden to engage young people to plant the seeds for the love of gardening at an early age.

Possible gardeners include:

- *Gardening Clubs*
- *4-H Groups*
- *Retirement Communities*
- *Boy/Girl Scouts*
- *Apartment Renters*
- *Church Groups*
- *Businesses*
- *Day Cares*

Bob Carey - Host of Radio's Garden Talk and Horticulturalist writer for Harrisburg's Magazine says *"The Community Garden at Ames in the heart of Shiremanstown may well become the area's new village commons as neighbors get their fingernails dirty and swap tips and tales as they learn on their Ames-supplied tools."*



How Do I *Sign Up?*

If you are interested in a Community Garden plot, please contact one of the following Administrators from the Penn-Cumberland Garden Club, Lea Smart and Susan Wilder at the address below:

Email: commveggarden@gmail.com

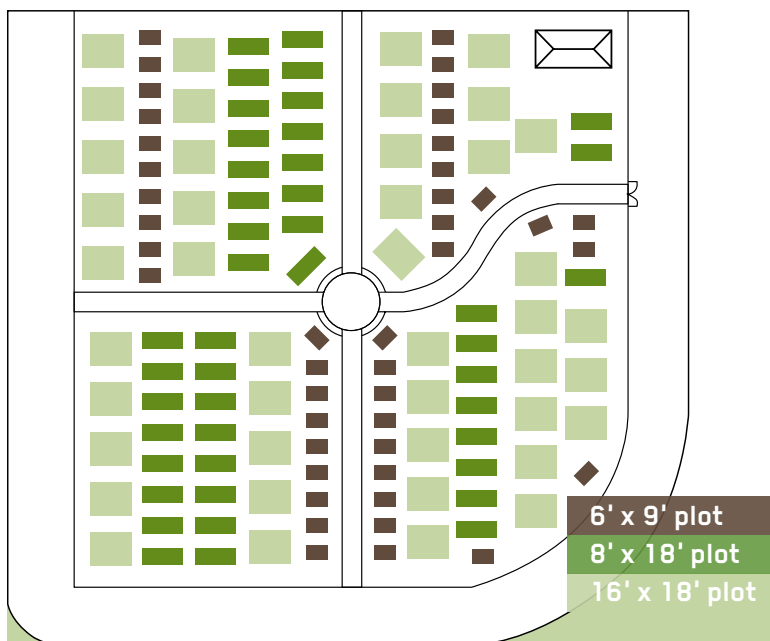

Opening in the spring of 2011, Ames Community Garden provides 129 plots to gardeners in the community.

America's *Oldest Gardener*



Established in 1774, Ames has been a part of gardening in America since

before the founding of our country. Headquartered in Camp Hill, PA, Ames is the leading North American manufacturer and marketer of non-powered lawn and garden tools, wheelbarrows, and other outdoor work products to the retail and professional markets.



Our Partner in *Serving the Community*

Penn-Cumberland Garden Club was organized in 1959, federated in September, 1960 and is a member of the Garden Club Federation of PA, District IV, and the Central Atlantic Region of National Garden Clubs, Inc.



Penn-Cumberland Garden Club

OUR CLUB PURPOSE:

- To develop the art of gardening among members.
- To enlarge interest and activity in civic beautification.
- To promote the conservation of trees, plants, bird life and natural resources.
- To appreciate the art of flower arranging.
- To further the study of plants, gardening, landscape design and conservation.
- To promote interest among members and others through educational programs.



© 2014 THE AMES COMPANIES, INC.
465 RAILROAD AVE. CAMP HILL, PA 17011
WWW.CORPORATE.AMES.COM
GR4540