

**TO REPLACE CRANK ON WROUGHT IRON HOSE REEL:**

1. Remove all hose from reel.
2. Flip unit upside down.
3. Using a driver with Phillips head end, reach into hose reel where shown and remove Crank Retaining Screw with Cap from inside of Housing:

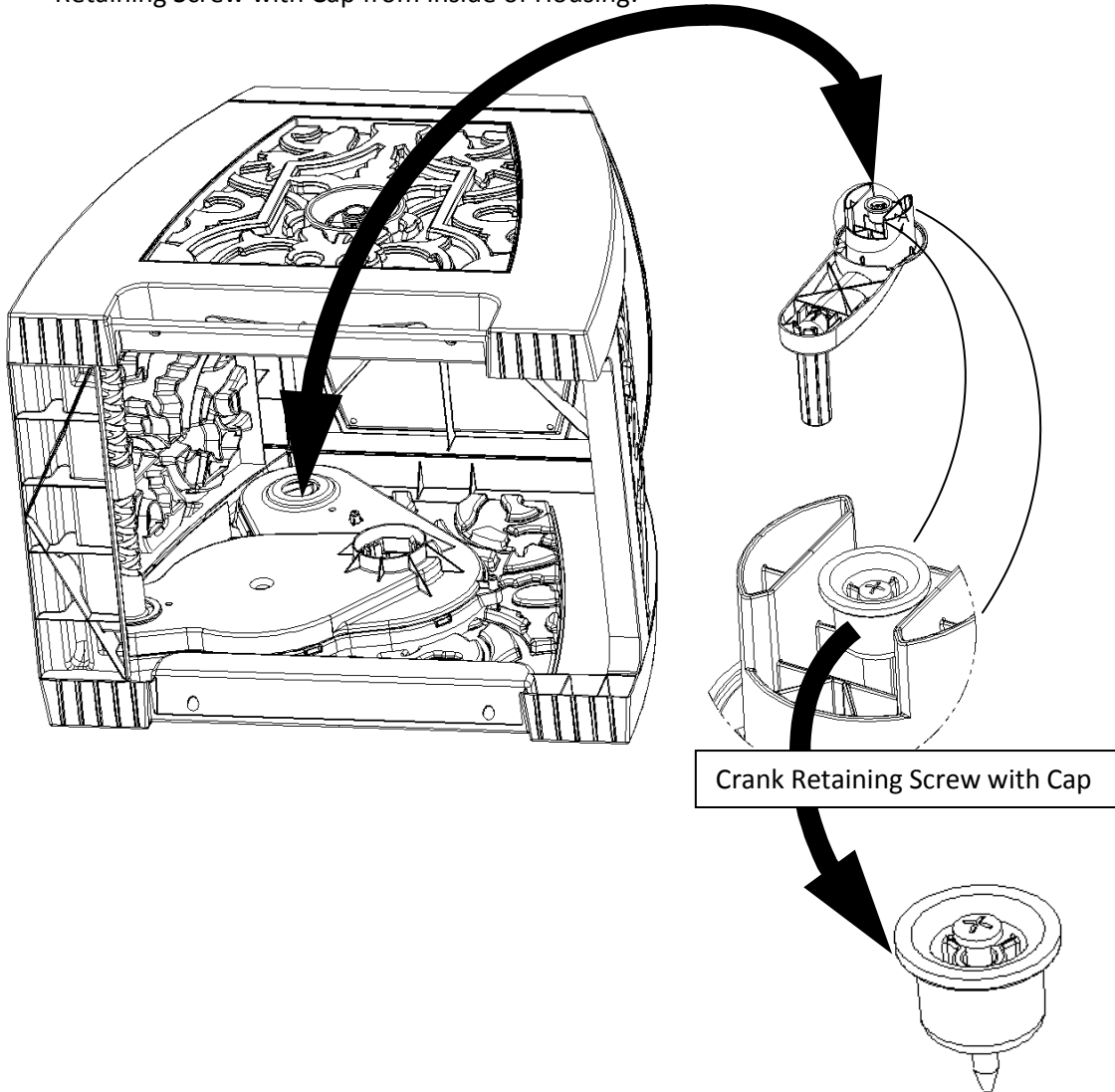

4. Before removal of existing Crank from outside of Housing, take note of how it is seated in Housing then remove existing Crank.
5. Remove Crank Bushing from existing Crank and reinstall on replacement part.

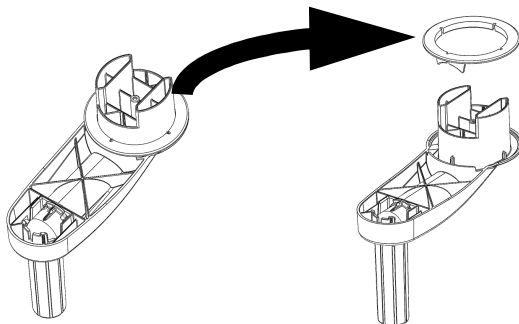

6. Install new Crank into outside part of Housing and replace Crank Retaining Screw with Cap on inside of Housing by tightening it with Phillips head driver.